

Content Controls in Libby

Access for all, while giving users tools to make personal content decisions

CONTENT CONTROLS:

Libby's "Content Controls" is an optional setting that allows users to configure what library content appears in Libby, for themselves or their family.

HOW IT WORKS:

Using data from publishing partners, every book, audiobook, and magazine is assigned one of four audiences: mature content, general content, young adult, and juvenile. Content Controls introduce settings that allow Libby users to limit their personal access to titles according to these audience levels.

STANDARD AUDIENCE LEVELS:

Content Controls let you make fine-grained choices about exactly how the app will limit access to content with three prominent presets:

 **Libby for Everyone** works just like Libby does today, with no restrictions by audience except those you manually choose to apply.

 **Libby for Kids** automatically filters out "mature content" and "general content" in library collections. You can apply this to deep-search, sample, and circulation restrictions as well "young adult" titles.

 **Libby for Grown-ups** is for people who borrow adult titles only. It hides juvenile and young adult titles from appearing.

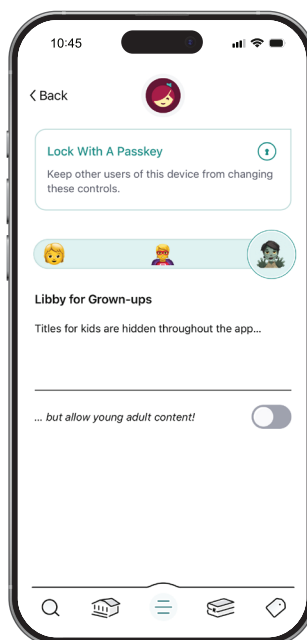
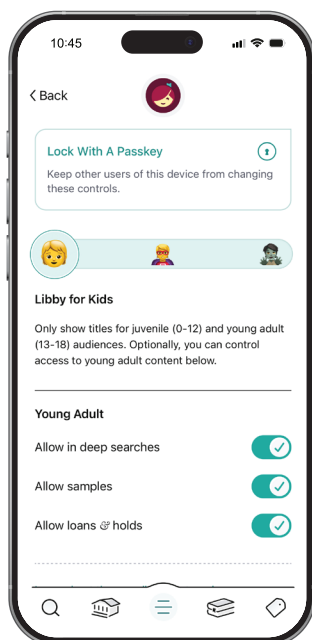
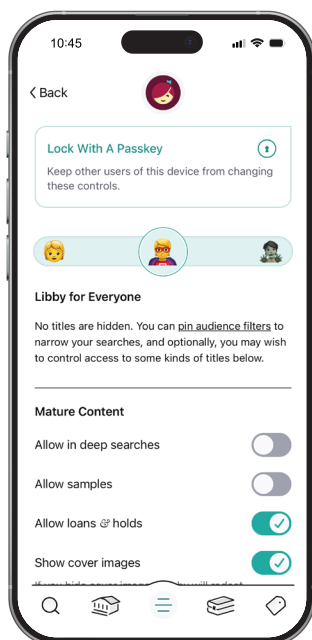

Libby.
The library reading app.

For more information contact your account manager.

OverDrive

A world enlightened by reading

company.overdrive.com
libraryteam@overdrive.com
(216) 573-6886